

1 2 3 4 5 6 7 8

REV	LOCATIONS	DESCRIPTION	DATE	REVISER	APPD
1	△	Size changes	05/JAN/22	MATT	CHERRY

**SPECIFICATIONS**

**Electrical**

Current Rating: 2.0A AC(rms)/DC  
 Voltage Rating: 250V AC(rms)/DC  
 Contact Resistance: 20 mΩ Max  
 Insulation Resistance: 1000 MΩ MIN  
 Withstanding Voltage: 500V AC r.m.s  
 Temperature Range—Operating: -40°C~+105°C

**Material and Plating**

Housing: PBT (UL94V-0)  
 Contact: Brass  
 Plating: Selective gold in contact area,  
 Nickel on tail

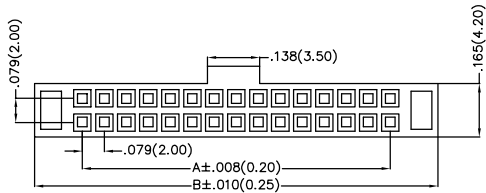
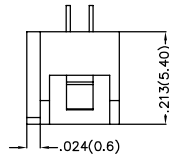
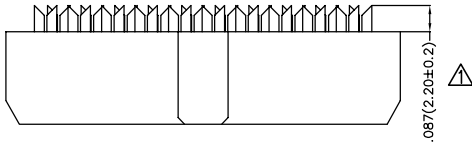
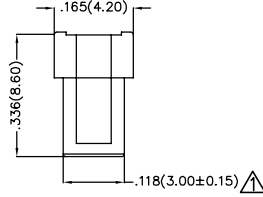
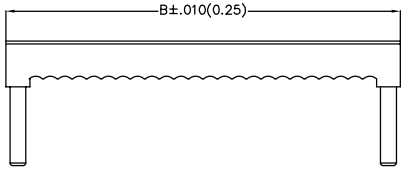

**Ordering Information**

FID 200 01 — XX 3 K6 K  
 1 2 3 4 5 6 7

1	Category	2	Series Number	3	Distinction No.	4	Circuits	5	Plating	6	Color—Resin	7	Packaging
	FID—IDC		200—Pitch 2.00mm		01		XX		3—Selective gold in contact area, Nickel on tail		K6—Black		K—Tray

Circuits (n)	Part No.	Dimensions(in/mm)		Circuits (n)	Part No.	Dimensions(in/mm)	
		A	B			A	B
6	FID20001-063K6K	.157(4.00)	.441(11.20)	24	FID20001-243K6K	.866(22.00)	1.150(29.20)
8	FID20001-083K6K	.236(6.00)	.517(13.20)	26	FID20001-263K6K	.945(24.00)	1.228(31.20)
10	FID20001-103K6K	.315(8.00)	.598(15.20)	28	FID20001-283K6K	1.024(26.00)	1.306(33.20)
12	FID20001-123K6K	.394(10.00)	.677(17.20)	30	FID20001-303K6K	1.102(28.00)	1.386(35.20)
14	FID20001-143K6K	.472(12.00)	.756(19.20)	34	FID20001-343K6K	1.260(32.00)	1.543(39.20)
16	FID20001-163K6K	.551(14.00)	.835(21.20)	36	FID20001-363K6K	1.339(34.00)	1.622(41.20)
18	FID20001-183K6K	.630(16.00)	.913(23.20)	40	FID20001-403K6K	1.496(38.00)	1.780(45.20)
20	FID20001-203K6K	.709(18.00)	.992(25.20)	44	FID20001-443K6K	1.654(42.00)	1.937(49.20)
22	FID20001-223K6K	.787(20.00)	1.071(27.20)	50	FID20001-503K6K	1.890(48.00)	2.173(55.20)

<p>THIRD ANGLE PROJECTION</p>	GENERAL TOLERANCES (UNLESS SPECIFIED)		APPROVE BY	DATE	PART NO.	ITEM NO.	<p>Leader Of Industry</p>
	X.±.012(0.30)	X:±5'	FRANK	9/SEPT/13	FID20001-XX3K6K	FID20001	
	X.X±.008(0.20)	.X'±2'	CHECKED BY	DATE	TITLE		
	X.XX±.006(0.15)	.XX'±1'	CHERRY	9/SEPT/13	Wire to Board(IDC Connector) Pitch 2.00mm		
SCALE	SIZE	X.XXX±.004(0.10)	.XXX'±0.5'	DRAWN BY	DATE	THIS DRAWING CONTAINS INFORMATION THAT IS PROPRIETARY TO TXGA INDUSTRIAL ELECTRONICS(S.Z)CO.,LTD AND SHOULD NOT BE USED WITHOUT WRITTEN PERMISSION	
5:1	A4			JACOB	9/SEPT/13	REV 1	SHEET NO. 1/1

1 2 3 4 5 6 7 8